



## Integrated LED Step Light

### STRL3MTBK

- Pre-installed photocell sensor.
- Energy savings dusk to dawn feature turns the LEDs ON when it's dark and OFF when there is light.
- Motion detection, automatically turn the lights ON and turns the lights OFF after 1 minute when the space is vacated.
- Suitable for indoor and outdoor installation.
- Suitable for wet locations.
- 5 years warranty.

#### Lighting source



Power	3W ~ 120V
Brightness	85 Lumens
Color	3000K
Lifespan	25 000 Hours

#### Finish



Structure	Black
-----------	-------

#### Dimensions



Length	4 ¾ in. 120 mm
Width	1 ½ in. 37 mm
Height	3 in. 76 mm

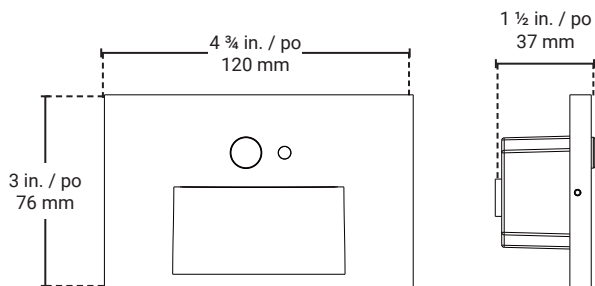

[daniel.goulet@bazz.ca](mailto:daniel.goulet@bazz.ca)

6000 Boulevard Thimens  
Saint-Laurent, Qc  
Canada, H4S 1S5  
1.800.931.4470  
[www.bazz.ca](http://www.bazz.ca)